

METRICS



**NEBRASKA-IOWA
INDUSTRIAL
FASTENERS CORP.**

www.neiafasteners.com

E-Mail: orders@neiafasteners.com

1-800-782-6342

8530 "K" Street

Omaha, NE 68127

Phone: (402) 592-4988

Fax: (402) 592-9271

8116 U.S. Highway 166
Arkansas City, KS 67005

Phone: (620) 442-7526

Fax: (620) 442-7583



www.nfc-usa.com

E-Mail: orders@nfc-usa.com

1-800-786-4658

1817 Jasper Street

Kansas City, MO 64116

Phone: (816) 221-8885

Fax: (816) 472-5555

2335 B-104 E. Chestnut Expwy.
Springfield, MO 65802

Phone: (417) 865-6246

Fax: (417) 865-0596

NOTES

Metrics Section V

CAPSCREWS

Button Head Socket (Class 10.9)	9
Flange (Class 10.9)	11
Flat Head Socket (Class 10.9)	9
Hex Head (Class 8.8)	
Extra Fine Thread Pitch	6
Fine Thread Pitch	5
Standard Thread Pitch	3, 4
Hex Head (Class 10.9)	7
Socket Head (Class 12.9)	8

MACHINE SCREWS

Phillips Oval Head	15
Phillips Pan Head	15
Slotted Pan Head	15

NUTS

Flange	11
Hex	
Class 8.8	12
Class 10.9	13
Hex Crown Lock	13
Hex Dome Cap	13
Hex Jam	13
Nylon Lock	
Class 8.8	12
Class 10.9	12
Wing	13

PIPEPLUG

Steel	10
-------	----

SALES AIDS

General Information	1
Markings	2
Metric Pitch Gauge	15

SETSCREWS

Socket (Class 12.9)	10
---------------------	----

THREADED ROD

10a

WASHERS

External Tooth Lock	14
Flat	14
Split Lock	14
Wavy Spring	14

NOTES

GENERAL INFORMATION

IDENTIFICATION: Metric screw threads are identified by a letter M for the thread form profile.

THREAD PITCH: In the metric system pitch is used instead of threads per inch. Pitch refers to the distance in millimeters between the crest of each thread.

METRIC CONVERSION: To convert length to millimeters multiply inches by 25.4. (*1 inch equals 25.4 mm*)
To convert length to inches multiply millimeters by .039370.

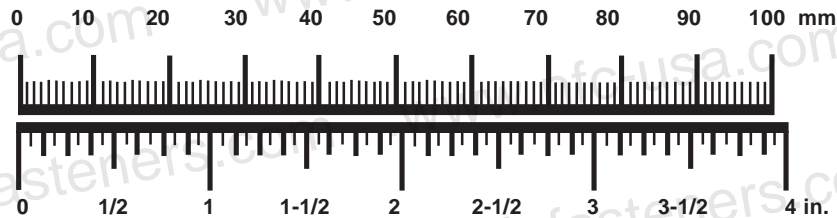

WRENCH SIZE: We have shown wrench size for all hex head cap screws - this is the same as "distance across the flats."

MARKING: Marking for all property classes 8.8 and higher is required for each screw of nominal diameter M5 (.2") and larger. For additional ISO requirements, see next page.

Metric Basics of Most Commonly Used Sizes

Nominal Bolt Diameter	Coarse Thread Pitch	Fine Thread Pitch	Extra-Fine Thread Pitch	Distance Across Flats	Wrench Size (MM)
3 mm	.50			5.5 mm	5.5
4 mm	.70			7 mm	7
5 mm	.80			8 mm	8
6 mm	1.00			10 mm	10
7 mm	1.00			11 mm	11
8 mm	1.25	1.00		13 mm	13
10 mm	1.50	1.25	1.00	17 mm	17
12 mm	1.75	1.50	1.25	19 mm	19
14 mm	2.00	1.50		22 mm	22
16 mm	2.00	1.50		24 mm	24
18 mm	2.50			27 mm	27
20 mm	2.50			30 mm	30
22 mm	2.50			32 mm	32
24 mm	3.00			36 mm	36
30 mm	3.50			46 mm	46

GENERAL INFORMATION

METRIC BOLTS, SCREWS, STUDS AND NUTS

MARKING SYMBOLS AND IDENTIFICATION

STEEL Ref. No.: ISO 898/1 - 1988

HEXAGON BOLTS AND SCREWS

Hexagon bolts and screws should be marked with the designation symbol of the property class. The marking is obligatory for all property classes, preferably on the top of the head by indenting or embossing or on the side of the head by indenting. Marking is required for hexagon bolts and screws with the nominal thread diameters 5 mm and larger.

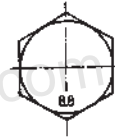

Preferable

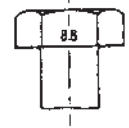

Acceptable

SOCKET HEAD CAP SCREWS

Socket head cap screws should be marked with the designation symbol of the property class. The marking is obligatory for property classes equal to or higher than 8.8, preferably on the side of the head by indenting or on the top of the head by indenting or embossing. Marking is required for socket head cap screws with nominal thread diameters 5 mm and larger.



Preferable

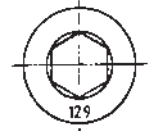

Acceptable

MARKING SYMBOLS

Property Class	3.6	4.6	5.6	6.8	8.8	9.8	10.9	12.9	
Marking Symbol*	3.6	4.6	5.6	5.6	6.8	8.8	9.8	10.9	12.9

* The period in the marking symbol may be omitted. When low carbon martensitic steel is used for property class 10.9, the symbol shall be underlined. Trade (identification) marking of the manufacturer is mandatory on all products which are marked with property classes.

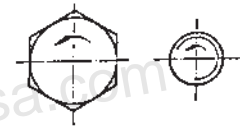

Left-hand thread marking

LEFTHAND THREAD BOLTS AND SCREWS

Bolts and screws with left-hand thread shall be marked with symbols shown either on the top of the head or on the point. Marking is required for bolts and screws with nominal thread diameter 5 mm and larger.

STUDS

Studs shall be marked with the designation symbol of the property class. Marking is obligatory for property classes equal to or higher than 8.8, preferably on the extreme end of the threaded portion by indenting. For studs with interference fit, the marking shall be at the nut end. Marking is required for studs with nominal thread diameter equal to or greater than 5 mm.

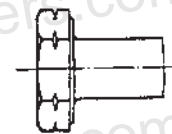

Alternative left-hand thread marking

Tightening Torques - Electrically Zinc Plated - Friction Coefficient 0.125

PROPERTY CLASS	TORQUE Ma	NOMINAL DIAMETER - COARSE THREAD																		
		M3	M4	M5	M6	M7	M8	M10	M12	M14	M16	M18	M20	M22	M24	M27	M30	M33	M36	M39
5.6	Nm	0.56	1.28	2.50	4.3	7.1	10.5	21	38	58	88	121	171	230	295	435	590	800	1030	1340
	ft/lb	0.41	0.94	1.84	3.1	5.2	7.7	15	28	42	64	89	128	169	217	320	435	590	759	988
8.8	Nm	1.28	2.90	5.75	9.9	16.5	24	48	83	132	200	275	390	530	675	995	1350	1830	2360	3050
	ft/lb	0.94	2.14	4.24	7.3	12.1	17.7	35	61	97	147	202	287	390	497	733	995	1349	1740	2249
10.9	Nm	1.80	4.10	8.1	14	23	34	67	117	185	285	390	550	745	960	1400	1900	2580	3310	4290
	ft/lb	1.33	3.02	5.97	10.3	16.9	25	49	86.2	136	210	287	405	549	708	1032	1401	1902	2441	3163
12.9	Nm	2.15	4.95	9.70	16.5	27	40	81	140	220	340	470	660	890	1140	1680	2280	3090	3980	5150
	ft/lb	1.59	3.65	7.15	12.1	19.9	29	59	103	162	250	348	488	658	840	1239	1681	2278	2935	3798

PROPERTY CLASS	TORQUE Ma	NOMINAL DIAMETER - FINE THREAD								
		M8 x 1	M10 x 1.25	M12 x 1.25	M14 x 1.5	M16 x 1.5	M18 x 1.5	M20 x 1.5	M22 x 1.5	M24 x 2
8.8	Nm	25	49	88	140	210	305	425	570	720
	ft/lb	18	36	64	103	154	224	313	420	531
10.9	Nm	35	68	125	195	295	425	600	800	1000
	ft/lb	25	50	92	143	217	313	442	590	737
12.9	Nm	42	82	150	235	350	510	720	960	1200
	ft/lb	30	60	110	173	258	376	531	708	885

HEX HEAD CAP SCREWS

Standard Thread Pitch Heat Treated Alloy Steel

Class 8.8 - Zinc Plated
Equivalent to Grade 5 Strength

- DIN933 (Fully Threaded)
- * Asterisk denotes fully threaded
- DIN931 (Partially Threaded)

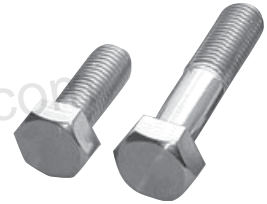

Diameter:	4 mm	5 mm	6 mm	7 mm	8 mm	10 mm	12 mm	14 mm	16 mm
Pitch:	.70	.80	1.00	1.00	1.25	1.50	1.75	2.00	2.00
Wrench Size:	7	8	10	11	13	17	19	22	24
Length									
6	60004*								
8	60008*	60049*							
10	60010*	60050*	60090*						
12	60012*	60052*	60092*	60142*	60192*				
16	60014*	60054*	60094*	60144*	60194*				
20	60016*	60056*	60096*	60146*	60196*	60256*			
25	60017	60057*	60097*	60147*	60197*	60257*	60307*	60377*	
30		60058	60098	60148	60198*	60258*	60308*	60378*	60448*
35		60059	60099	60149	60199	60259*	60309*	60379*	60449*
40		60060	60100	60150	60200	60260	60310*	60380*	60450*
45		60061	60101		60201	60261	60311	60381*	60451*
50		60062	60102		60202	60262	60312	60382	60452*
55					60203	60263	60313	60383	60453
60			60104		60204	60264	60314	60384	60454
65					60205	60265	60315	60385	60455
70			60106		60206	60266	60316	60386	60456
75					60207	60267	60317	60387	60457
80					60208	60268	60318	60388	60458
90					60210	60270	60320	60390	60460
100					60212	60272	60322	60392	60462
110					60214	60274	60324	60394	60464
120					60216	60276	60326	60396	60466
130					60218	60278	60328	60398	60468
140					60220	60280	60330	60400	60470
150					60222	60282	60332	60402	60472
160					60224	60284	60334		60474
170									
180						60288	60338	60408	60478
190							60340		
200							60342		60482
220							60346		60486
240									
260									60494
280									
300									

Items in bold discontinued,
when out of stock!

HEX HEAD CAP SCREWS

Standard Thread Pitch

Class 8.8 - Zinc Plated
Equivalent to Grade 5 Strength

Heat Treated Alloy Steel

- DIN 933 (Fully Threaded)
- * Asterisk denotes fully threaded
- DIN 931 (Partially Threaded)

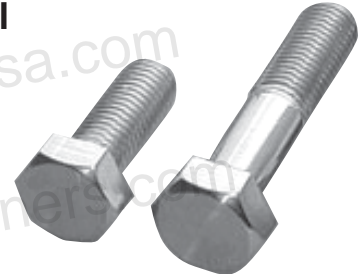

Diameter:	18 mm	20 mm	24 mm	30 mm
Pitch:	2.50	2.50	3.00	3.50
Wrench Size:	27	30	36	46
Length				
6				
8				
10				
12				
16				
20				
25				
30	60540*			
35	60541*			
40	60542*	60620*		
45	60543*	60622*		
50	60545*	60623*		
55	60546*	60624*		
60	60547	60625*		
65	60548	60626		
70	60549	60627		
75	60550	60628		
80	60551	60629		
90	60553	60631		
100	60555	60633		
110		60635		
120		60637		
130		60639		
140				
150		60643	60743	60843
160				
170				
180				
190				
200				60853
220				
240				
260				60865
280			60769	
300				

*Items in bold discontinued,
when out of stock!*

HEX HEAD CAP SCREWS

Fine Thread Pitch

Class 8.8 - Zinc Plated

Equivalent to Grade 5 Strength
Standard Head

Heat Treated Alloy Steel

- DIN 961 (Fully Threaded)
- * Asterisk denotes fully threaded
- DIN 960 (Partially Threaded)



Diameter:	8mm	10mm	12mm	14mm	16mm
Pitch:	1.00	1.25	1.50	1.50	1.50
Wrench Size:	13	17	19	22	24
Length					
16	61194*	61255*			
20	61196*	61256*	61306*		
25	61197*	61257*	61307*		
30	61198*	61258*	61308*	61378*	61448*
35	61199	61259*	61309*		
40	61200	61260*	61310*	61380*	61450*
45		61261*			
50	61202	61262*	61312	61382*	61452*
55		61263			
60	61204	61264	61314	61384	61454
65					61455
70		61266	61316	61386	61456
75		61267			
80		61268	61318	61388	61458
90		61270			
100		61272	61322		61462
110		61274			

HEX HEAD CAP SCREWS

Extra Fine Thread Pitch

Class 8.8 - Zinc Plated

Equivalent to Grade 5 Strength

Heat Treated Alloy Steel

- DIN961 (Fully Threaded)
- * Asterisk denotes fully threaded
- DIN960 (Partially Threaded)

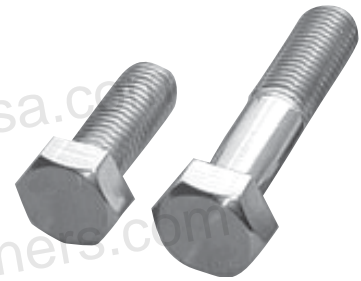

Diameter:	10mm	12mm	18mm
Pitch:	1.00	1.25	1.50
Wrench Size:	17	19	27
Length			
20	62256*		
25	62257*	62307*	
30	62258*	62308*	
35	62259*	62309*	
40	62260*	62310*	
45		62311*	62351*
50	62262	62312*	
65	62264	62314	
70	62266	62316	
80	62268	62318	
90			62370
100			62372
120			62374

HEX HEAD CAP SCREWS

Standard Thread Pitch

Class 10.9 - Zinc Plated

Equivalent to Grade 8 Strength

Heat Treated Alloy Steel

- DIN 933 (Fully Threaded)
- * Asterisk denotes fully threaded
- DIN 931 (Partially Threaded)

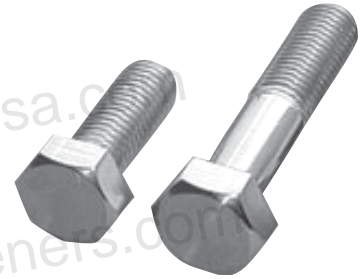

Diameter:	6mm	8mm	10mm	12mm	14mm	16mm	20mm
Pitch:	1.00	1.25	1.50	1.75	2.00	2.00	2.50
Wrench Size:	10	13	17	19	22	24	30
Length							
10	63167*						
12	63168*	63194*					
16	63169*	63195*	63255*				
20	63170*	63196*	63256*	63306*			
25	63171	63197*	63257*	63307*	63403*		
30	63172	63198*	63258*	63308*	63404*		
35	63173	63199	63259*	63309*	63405*		
40	63174	63200	63260	63310*	63406*	63450*	
45	63175	63201	63261	63311		63451*	
50	63176	63202	63262	63312	63408*	63452*	
55	63177	63203	63263	63313			
60	63178	63204	63264	63314	63410	63454	63626*
65	63179	63205	63265	63315			
70	63180	63206	63266	63316	63412	63456	63628
75		63207	63267	63317			
80		63208	63268	63318	63414	63458	63630
90		63210	63270	63320	63416		63632
100		63212	63272	63322	63418	63462	63634
110		63214	63274	63324	63419	63464	63636
120		63216	63276	63326	63420	63466	63638
130		63218	63278	63328	63421		63640
140		63220	63280	63330	63422	63470	63642
150		63222	63282	63332	63423	63472	63644
160			63284	63334	63424	63474	63646
180				63338	63426	63478	63648
200				63342	63428	63482	
260						63494	

SOCKET HEAD CAP SCREWS

Standard Thread Pitch

Class 12.9 - Black Oxide Finish

Exceeds Grade 8 Strength

177,000 psi minimum Tensile Strength

• DIN 912



Diameter:	4mm	5mm	6mm	8mm	10mm	12mm	16mm	20mm
Pitch:	.70	.80	1.00	1.25	1.50	1.75	2.00	2.50
Key Size:	3	4	5	6	8	10	14	17
Length								
5	64008							
6								
8		64050						
10			64090					
12	64012	64052	64092	64192				
16	64014	64054	64094	64194				
20	64016	64056	64096	64196	64256			
25	64017	64057	64097	64197	64257			
30	64018	64058	64098	64198	64258	64308	64448	
35			64099	64199	64259	64309		
40		64060	64100	64200	64260	64310	64450	
45			64101	64201	64261			
50			64102	64202	64262	64312	64452	
60				64204	64264	64314	64454	64625
70				64206	64266	64316	64456	64627
80				64208	64268	64318	64458	64629
90						64320		
100						64322	64462	64633
110								
120								

**Other sizes available by special order.
Please allow 5 days to 3 weeks for delivery.**

SOCKET CAP SCREWS

Flat Head Socket Cap Screws

Standard Thread Pitch

Class 10.9 - Heat Treated Steel

Black Finish

Equivalent to Grade 8 Strength

• DIN 7991



Diameter:	3mm	4mm	5mm	6mm	8mm	10mm	12mm
Pitch:	.50	.70	.80	1.00	1.25	1.50	1.75
Key Size:	2	2.5	3	4	5	6	8
Length							
6		65008					
8	64990	65009	65049	65088			
10	64991	65010	65050	65090			
12	64992	65012	65052	65092	65194		
16	64993	65014	65054	65094	65195		
20		65016	65056	65096	65196	65256	65306
25		65017	65057	65097	65197	65257	
30			65058	65098	65198	65258	
35			65059			65259	
40				65100	65200	65260	
45							
50							
55							
60					65204		65314

Button Head Socket Cap Screws

Standard Thread Pitch

Class 10.9 - Heat Treated Steel

Black Finish

Equivalent to Grade 8 Strength

• DIN 7380

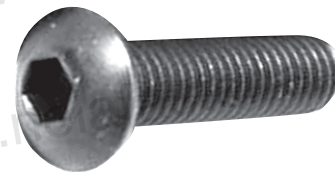

Diameter:	3mm	4mm	5mm	6mm	8mm
Pitch:	.50	.70	.80	1.00	1.25
Key Size:	2	2.5	3	4	5
Length					
6	66604	66620			
8	66605	66621			
10	66606		66642		
12	66607	66623	66643	66659	66678
16		66625	66645	66661	66680
20			66646	66662	66681
25			66647	66663	66682
30			66648	66664	66683

METRICS

SOCKET SET SCREWS

Standard Thread Pitch
Class 12.9 - Black Oxide Finish
Cup Point

DIN 916



Diameter:	3mm	4mm	5mm	6mm	8mm	10mm	12mm
Pitch:	.50	.70	.80	1.00	1.25	1.50	1.75
Key Size:	1.5	2	2.5	3	4	5	6
Length							
3	65621						
4	65622	65634					
5	65623	65635					
6	65624	65636	65646	65686			
8		65637	65648	65688	65788		
10		65638	65650	65690	65790	65850	
12		65639	65652	65692	65792	65852	65950
16				65694	65794	65854	65952
20			65656	65696	65796	65856	65954
25				65698	65798	65857	65956
30					65800		

- *Deep hex socket prevents wrench from slipping*
- *Deep cup point bites into shafts and resists vibration*

Steel Pipe Plug

DIN 906

Diameter:	18mm
Pitch:	1.5
Key Size:	8
Length	
10	69018



METRICS

THREADED ROD

Metric Threaded Rod Zinc Plated



Diameter Thread	Meter Length Part No.
4 x .70	93874
5 x .80	93989
6 x 1.00	93990
8 x 1.25	93991
10 x 1.50	93992
12 x 1.75	93875
16 x 2.00	93877

NOTES

Lined area for notes, containing a large rectangular box at the top and horizontal lines below. The page is watermarked with 'www.neiafasteners.com' and 'www.nfc-usa.com' diagonally.

FLANGE BOLTS & NUTS

Metric Flange Bolts

* Zinc or zinc & yellow plated
 ** JIS B-1189 Small Head



Diameter:	6mm	8mm	10mm	12mm	16mm
Pitch:	1.00	1.25	1.50	1.75	2.00
Wrench Size:	10	12**	15**	16**	24
Length					
10	65901				
12	65903				
16	65902*				
20	65900*	65912			
25		65915			
30	65904	65914	65931	65925	65970
35		65916	65932*		
40		65917	65933	65927*	
45					
50			65935		

Metric Flange Nuts

Class 10
Din 6923
10.9 Zinc
Zinc Yellow



Part No.	Size	Thread Pitch
65992	6	1.00
65993	8	1.25
65994	10	1.50
65995	12mm	1.75
65996	14mm	2.00
65998	16mm	2.00

HEX NUTS

Metric Hex Nuts

Class 8.8 & 10.9 - Zinc Plated
Equivalent to Grade 5 Strength

DIN 934



8.8 Part No.	Diameter (mm)	Thread Pitch			10.9 Part No.
		Standard	Fine	Extra Fine	
66003	3	.50			
66004	4	.70			
66007	5	.80			
66010	6	1.00			66056
66013	7	1.00			
66016	8	1.25			66058
66017	8		1.00		
66022	10	1.50			66060
66023	10		1.25		
66024	10			1.00	
66028	12	1.75			66063
66029	12		1.50		
66030	12			1.25	
66031	14	2.00			66066
66032	14		1.50		
66034	16	2.00			66068
66035	16		1.50		
66037	18	2.50			66070
66039	18			1.50	
66041	20	2.50			66072
66042	20			1.50	
66044	22	2.50			
66046	22			1.50	
66048	24	3.00			
66050	24			1.50	
66052	30	3.50			

8.8 Part No.	Diameter (mm)	Thread Pitch			10.9 Part No.
		Standard	Fine	Extra Fine	
66204	4	0.70			
66207	5	0.80			
66210	6	1.00			66250
66213	7	1.00			
66216	8	1.25			66252
66217	8		1.00		66253
66222	10	1.50			66254
66223	10		1.25		66255
66224	10			1.00	
66228	12	1.75			66257
66229	12		1.50		66258
66230	12			1.25	
66231	14	2.00			66263
66232	14		1.50		66264
66234	16	2.00			66265
66235	16		1.50		
66237	18	2.50			66267
66241	20	2.50			66268

Hexagon Self Locking Nuts

with Nylon Insert

Class 8.8 & 10.9 - Zinc Plated

DIN 985



- Reusable
- Vibration Proof
- Shock Proof

For best locking results, 1-1/2 threads minimum must extend past the cone of the nut.

HEX NUTS

Crown lock Hex Nut



10.9 Zinc Plated

Part No.	Diameter (mm)	Thread Pitch		
		Standard	Fine	Extra Fine
66276	6	1.00		
66280	8	1.25		
66282	10	1.50		
66283	10		1.25	
66285	12	1.75		
66286	12		1.50	
66288	14	2.00		
66289	14		1.50	
66290	16	2.00		
66292	18	2.50		
66294	20	2.50		
66296	22	2.50		
66298	24	3.00		

Hexagon Jam Nuts



Zinc Plated
Class 4 Strength
DIN 439A = Non-Chamfered up to M10
DIN 439B = Chamfered M12 & up

Part No.	Diameter (MM)	Thread Pitch Standard
66310	6	1.00
66316	8	1.25
66322	10	1.50
66328	12	1.75

Hexagon Dome Cap Nuts



Zinc Plated
Class 6 Strength
DIN 1587

Part No.	Diameter (MM)	Thread Pitch Standard
66410	6	1.00

Wing Nut

Zinc Plated



Part No.	Diameter (MM)	Thread Pitch Standard
66420	6	1.00

WASHERS

Metric Flat Washers

Zinc Plated
DIN 125A



Part No.	Size	Inside Diameter	Outside Diameter	Thickness
67004	4	4.3	9	.80
67005	5	5.3	10	1.00
67006	6	6.4	12.5	1.60
67007	7	7.4	14	1.60
67008	8	8.4	17	1.60
67010	10	10.5	21	2.00
67012	12	13.0	24	2.50
67014	14	15.0	28	2.50
67016	16	17.0	30	3.00
67018	18	19.0	32	3.00
67020	20	21.0	37	3.00
67022	22	23.0	39	3.00
67024	24	25.0	44	4.00

Metric Wavy Spring Washers

Zinc Plated
DIN 137B

Material: Spring Steel



Part No.	Size	Inside Diameter	Outside Diameter	Thickness
67304	4	4.3	9	.50
67305	5	5.3	11	.50
67306	6	6.4	12	.50
67307	7	7.4	14	.80
67308	8	8.4	15	.80
67310	10	10.5	21	1.00
67312	12	13.0	24	1.20
67314	14	15.0	28	1.50
67316	16	17.0	30	1.50
67320	20	21.0	36	1.60
67324	24	25.0	44	1.80

Heat Treated

Metric Flat Washers

Zinc Plated
HV 200



Part No.	Size	Inside Diameter	Outside Diameter	Thickness
67106	6	6.4	12.5	1.60
67108	8	8.4	16	1.60
67110	10	10.5	20	2.00
67112	12	13.0	24	2.50
67114	14	15.0	28	2.50
67116	16	17.0	30	3.00
67118	18	19.0	34	3.00
67120	20	21.0	37	3.00
67122	22	23.0	39	3.00
67124	24	25.0	44	4.00

Helical Split Lock Washers

Zinc Plated
DIN 127B



Part No.	Size	Inside Diameter	Outside Diameter	Thickness
67904	4	4.1	7.6	.90
67905	5	5.1	9.2	1.20
67906	6	6.1	11.8	1.60
67907	7	7.1	12.8	1.60
67908	8	8.1	14.8	2.00
67910	10	10.2	18.1	2.20
67912	12	12.2	21.1	2.50
67914	14	14.2	24.1	3.00
67916	16	16.2	27.4	3.50
67918	18	18.2	29.4	3.50
67920	20	20.2	33.6	4.00
67922	22	22.5	35.9	4.00
67924	24	24.5	40.0	5.00

External Tooth Lock Washers

Zinc Plated
DIN 6797A

Material: Spring Steel



Part No.	Size	Inside Diameter	Outside Diameter	Thickness
67504	4	4.3	8	.50
67505	5	5.1	9	.50
67506	6	6.4	11	.70
67508	8	8.2	14	.80
67510	10	10.5	18	.90
67512	12	12.5	20.5	1.00

MACHINE SCREWS

Phillips Oval Head Machine Screws

Class 4.8
Zinc Plated
DIN 966

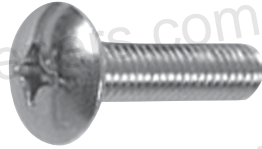

Standard Thread Pitch

Length (mm)	Diameter			
	4mm	5mm	6mm	8mm
10	68010	68050	68090	
12	68012	68052	68092	
16	68014	68054	68094	68194
20	68016	68056	68096	
25	68017	68057	68097	
30	68018	68058	68098	
35			68099	
40			68100	

Slotted Pan Head Machine Screws

Class 4.8
Zinc Plated
DIN 85A



Standard Thread Pitch

Length (mm)	Diameter				
	4mm	5mm	6mm	8mm	10mm
6	68706				
8	68708				
10	68710	68750	68790		
12	68712	68752	68792		
16	68714	68754	68794		
20	68716	68756	68796	68856	
25	68717	68757	68798	68857	68957
30	68718	68758	68799		
40					

Phillips Pan Head Machine Screws

Class 4.8
Zinc Plated
DIN 7985

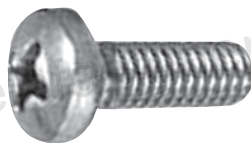

Standard Thread Pitch

Length (mm)	Diameter			
	4mm	5mm	6mm	8mm
8	68408			
10	68410	68450	68490	
12	68412	68452	68492	68592
16	68414	68454	68494	68594
20	68416	68456	68496	68596
25	68417	68457	68497	68597
30	68418	68458	68498	68598
35			68499	68599
40			68500	68600

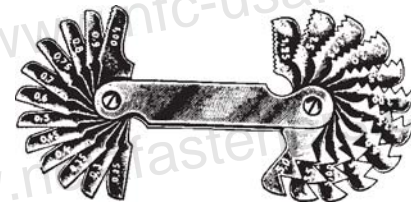

Metric Pitch Gauge

Part No. 00263

Also Available:
Standard "Inch"
Thread Gauge
Part No. 00264